

Area Safety Liaison Annual Training 2022

 UTHealth[®] Houston

Environmental
Health and Safety

Introductory Remarks

- Thank you for your service as an ASL!!!
- The ongoing COVID-19 pandemic has created incredible challenges for all of us, both professionally and personally, but we are extremely proud of everyone at UTHealth Houston!
- As an institution, we continue to persevere and grow – UTHealth Houston now has over 12,000 employees and nearly 6,000 students – so your service as an ASL is incredibly important

Overview – ASL Training 2022

- Welcome and thank you Area Safety Liaisons – Scott Patlovich, EHS
- Important and helpful phone numbers
- Review of recent incidents at UTHealth Houston
- Active Shooter Preparedness training – Officer Manuel Leston, UT Police
- Review of ASL roles and responsibilities – Snehal Rana, EHS
- Emergency preparedness, response, and communication – Bryan Evans, EHS

Safety, Health, Environment, and Risk Management

Safety, Health, Environment & Risk Management's (SHERM) mission is to work in conjunction with the UTHHealth community to ensure that education, research, and health care service activities take place in conditions that are optimally safe and healthy for all students, faculty, staff, visitors, surrounding community and the general public.



**Put simply, we exist to help people go home as healthy and safe as they arrived.
Please report any hazardous conditions to Environmental Health and Safety 713.500.8100**



ASL Duties

Report safety hazards to EHS

Report security concerns to UT Police

Facilitate evacuation during an emergency

- Assist with emergency evacuations and drills
- Help account for evacuated personnel
- Manage emergency evacuation assistance for individuals in your area (e.g. mobility impaired individuals)

Assist with AEDs

Help identify corridor or egress pathway blockages



ASLs Know Best

ASLs know their people, ASLs know their spaces

You are the eyes and ears for both safety and security in your area

Make sure you understand where your area of responsibility lies

ASLs On Campus

To be effective, ASLs must be present on campus

If you have been shifted to full time remote work, we suggest you consider shifting your ASL duties to another individual

We welcome your feedback and discussion on this matter!

Helpful Phone Numbers

UT Police Dispatch - (713) 792-2890

Emergencies - 911

Environmental Health & Safety - (713) 500-8100

Facilities, Planning & Engineering - (713) 500-3498
(a.k.a. the FIXT line)

Review of Recent Incidents

The following incidents have occurred at UTHealth
Houston over the past year

UTSD Burner Fire



Hanau Alcohol Torch

Use of unapproved space heaters



Excessive clutter
and potential fire
hazard – this is an
occupied space



Blocked Electrical Panels in Labs





Construction hazards

Quickly Identify and Report Water Leaks



Active Shooter Preparedness Training

Officer Manuel Leston, UT Police

- UTHHealth Houston President's Award for Leadership – demonstrates leadership through service for others
- Educator of the Quarter by MD Anderson - demonstrates excellence and innovative practices in education
- Selected as MD Anderson's Service Excellence Training program facilitator

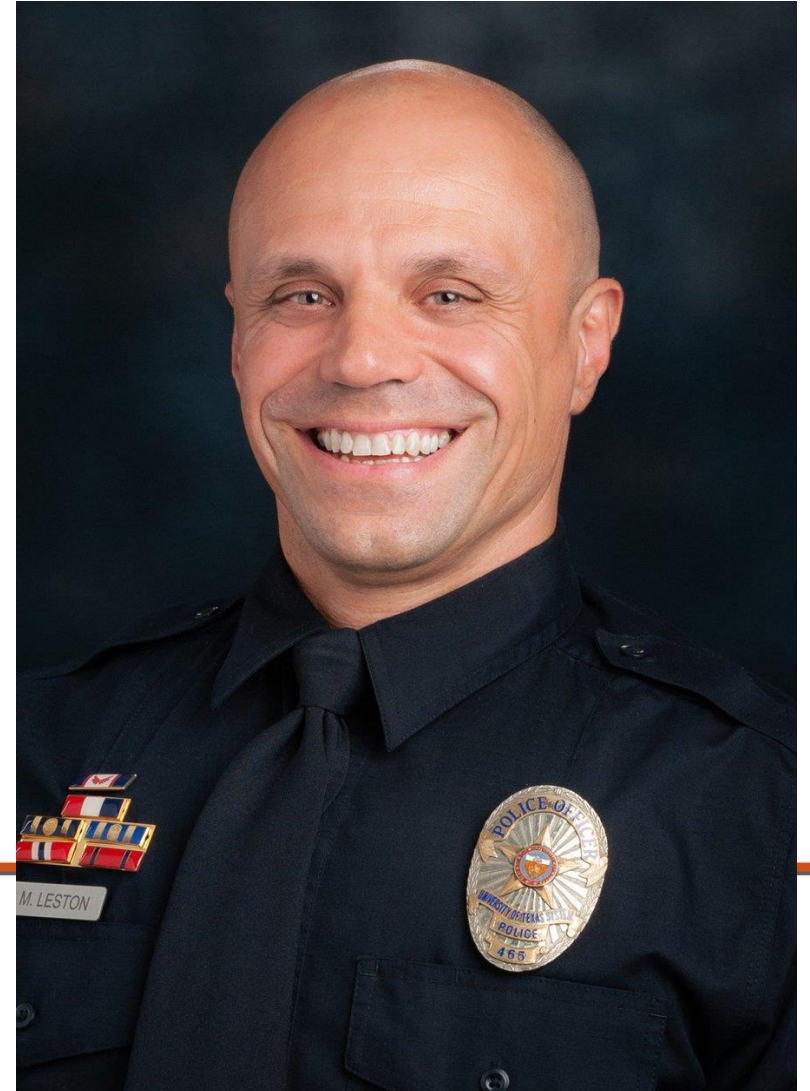

Emergency Preparedness and Communications

Bryan Evans

Safety Manager, Environmental Health & Safety

Area Safety Liaisons Roles and Responsibilities

Area Safety Liaison Program

Volunteer employees who assist with identifying health and safety concerns in their respective work area

Duties include, but are not limited to:

- Assist with drills and emergency evacuations
- Account for evacuated personnel in their respective area
- Assist with the identification and protection of mobility impaired individuals
- Assist with AEDs
- Notify EH&S of corridor and exit blockages
- Serve as a liaison between the University community and EHS



ASLs will have a red backpack in the event of a fire alarm

The Red Bag



Identifies you as the ASL – Wear during fire alarm and emergency events so others can identify you as the ASL

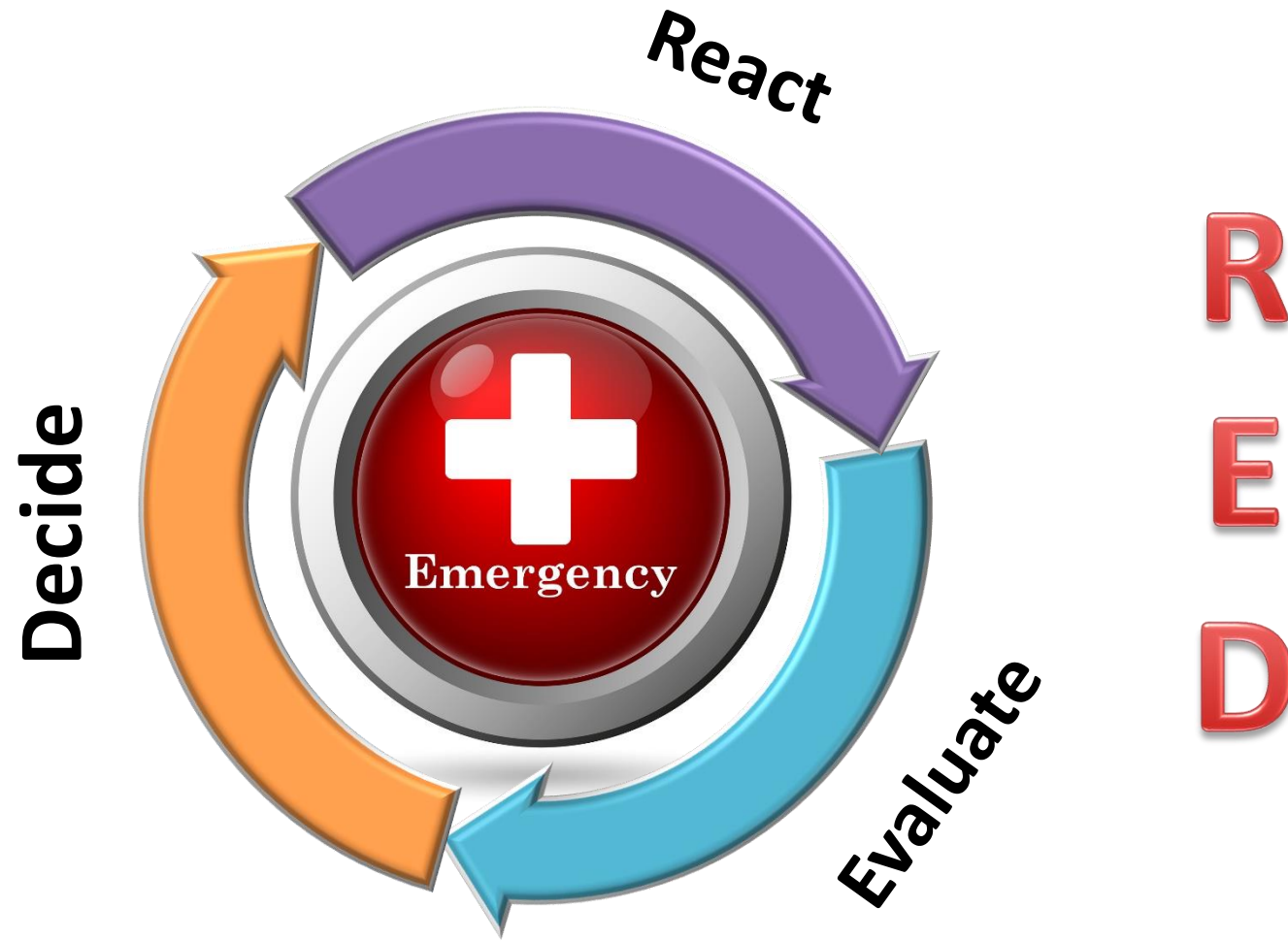

In an emergency...

In Case of Fire

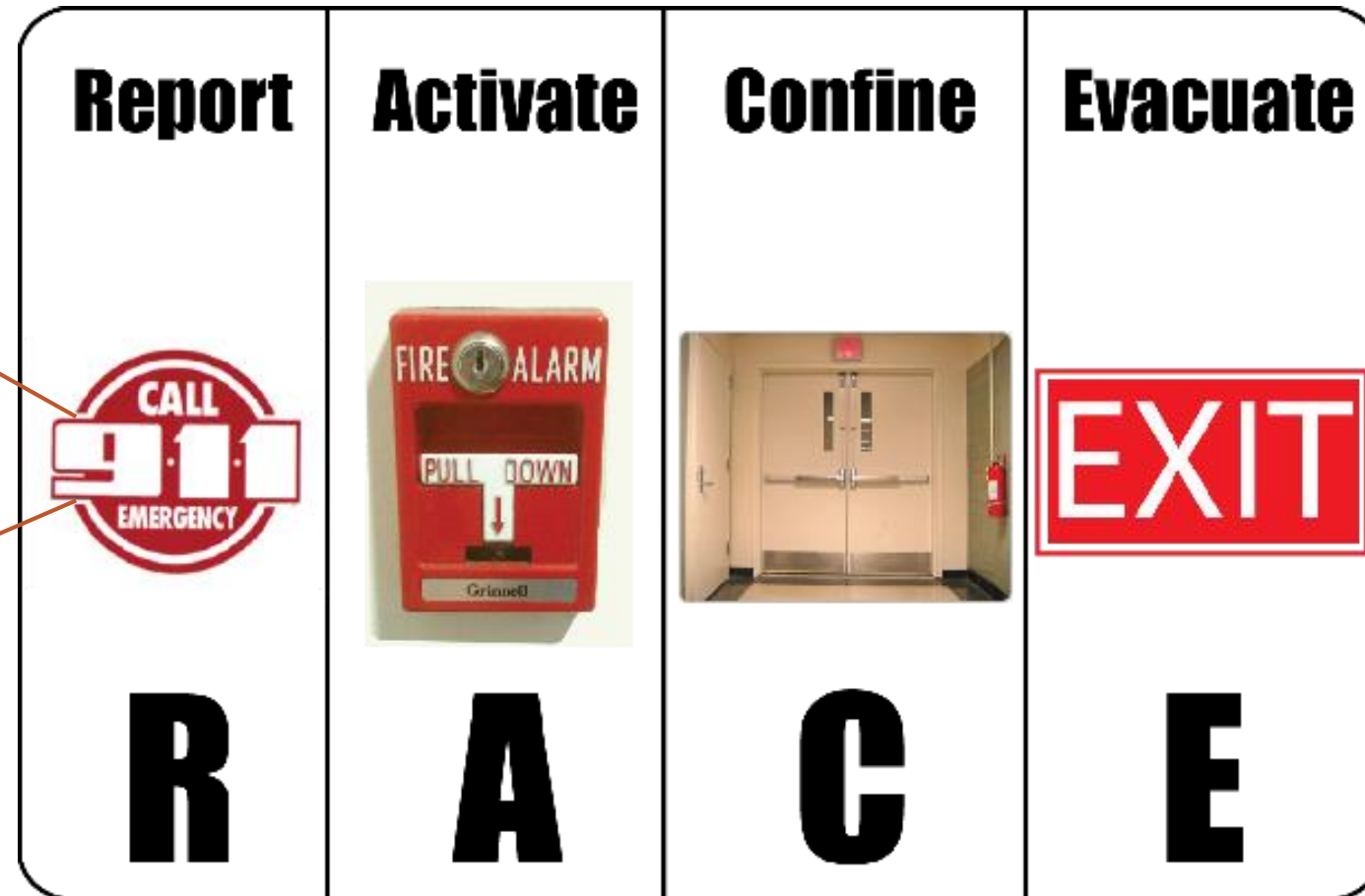

Have an Exit Strategy

KNOW:

- Two Escape Routes
- Pull station locations
- Fire Extinguisher Locations
- Meeting place outside of building



Fire Extinguishers

If you have been trained, use fire extinguishers to put out small fires

Remember P.A.S.S.

Pull the pin out

Aim the hose at the base of the fire

Squeeze the trigger

Sweep from side to side

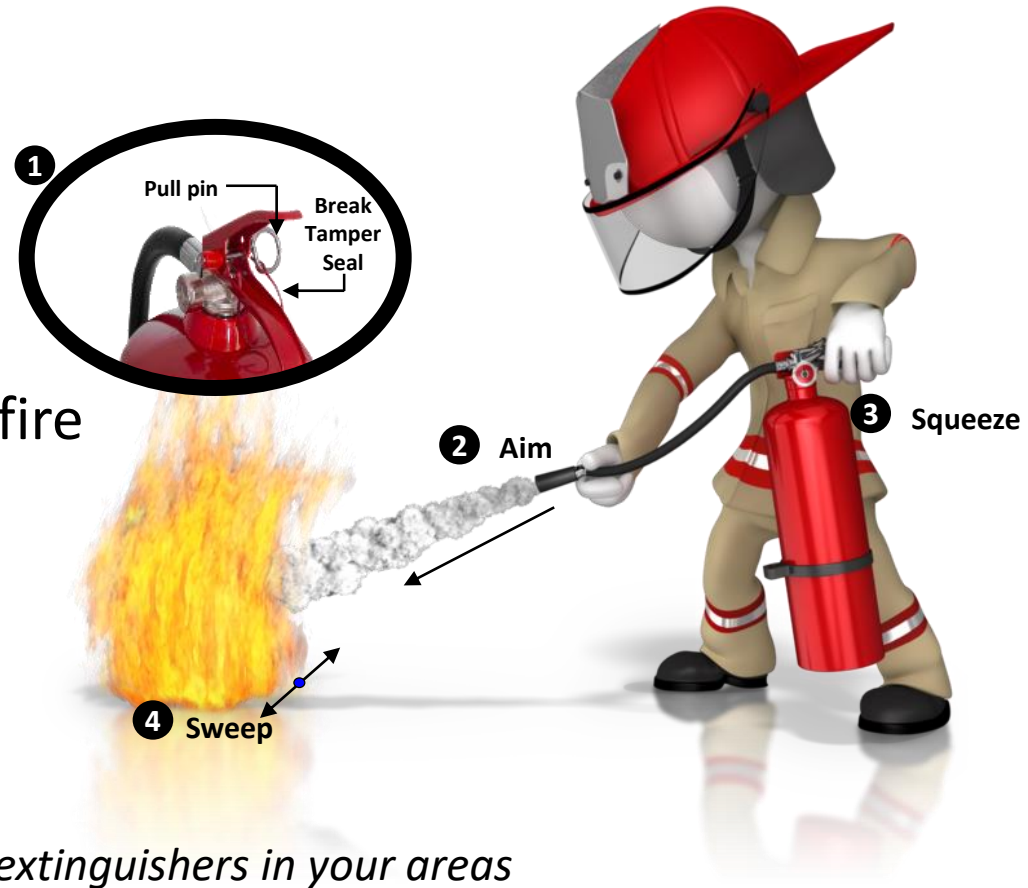

Please know the locations of fire extinguishers in your areas

High Rise Fire Alarm Notification

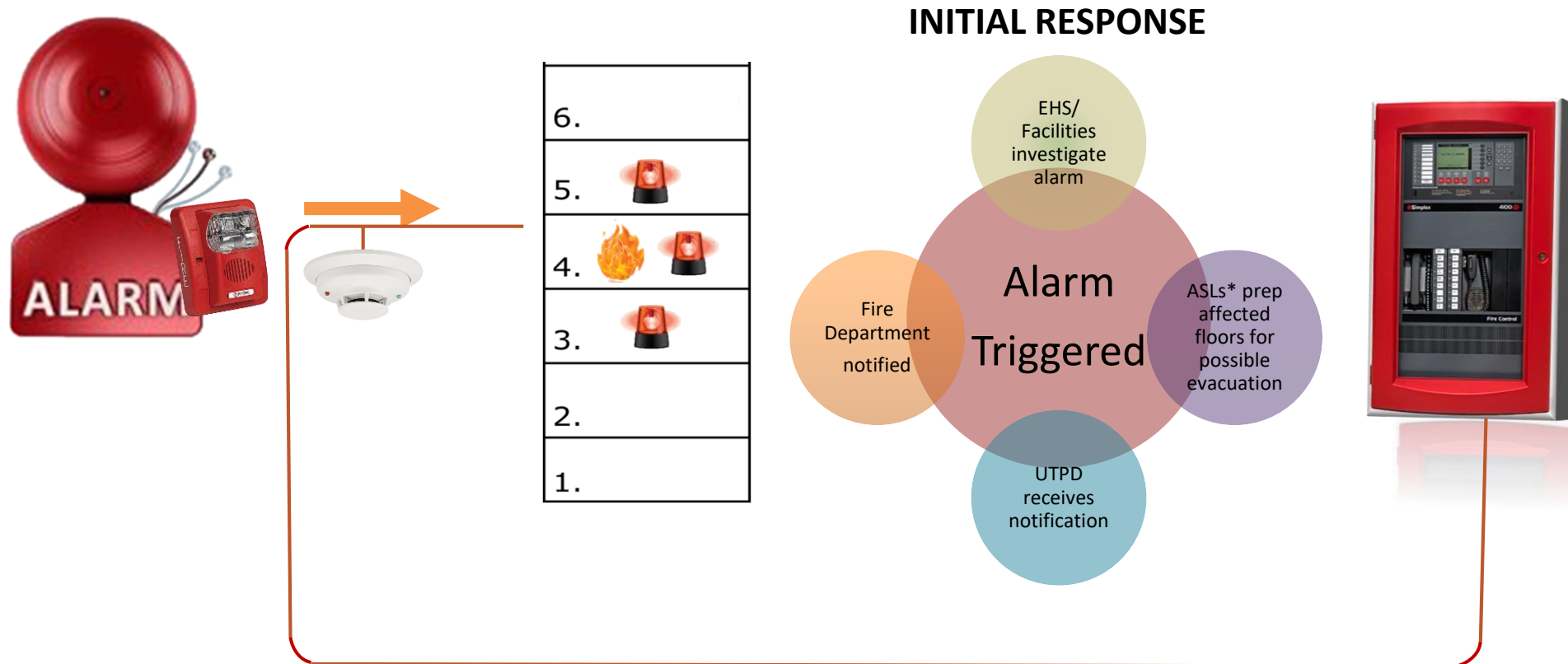

Do not hesitate - follow your evacuation plan immediately in a calm and orderly manner when a fire alarm has been activated. Do not use cellphone or other electronics until safety outside at your designated muster point.

Designated Evacuation Point

At least **75 ft.** away from building

**EXIT
STRATEGY**

*During an event, assist
keeping others calm
and coordinated*



Corridor Clearance – HOOP Policy 88

HOOP Policy is designed to keep the hallways, life safety equipment, and fire stairwells free and clear for those to access during an emergency event

No exterior hallways, fire exits, fire stairwells, fire extinguishers, eye wash stations, showers, or fire pull stations should be blocked – 3 feet clearance required

No rolling chairs, running electrical equipment, or combustible items in hallways or stairwells

Any items placed in hallways, should be approved by EHS with current labeled sticker about the owner

Contact EHS at 713 500 8100 with any questions

HOOP Policy 88 - Building Pathway Use



THEN

NOW



AEDs
located
near
elevators



Stop The Bleed Kits

*Based on UTHealth Houston Emergency Medicine faculty recommendations.

- 2x C.A.T.® Tourniquets
- 1x Israeli Emergency Bandage
- 2x Rolls Compressed Gauze
- 1x Pair Trauma Sheers
- 2x pair Nitrile Gloves
- 1x Eye/Face Shield
- 1x Roll Surgical Tape
- 1x Permanent Marker

Items do not expire

**Located within AED boxes to assist during physical trauma – does not require specialized training*

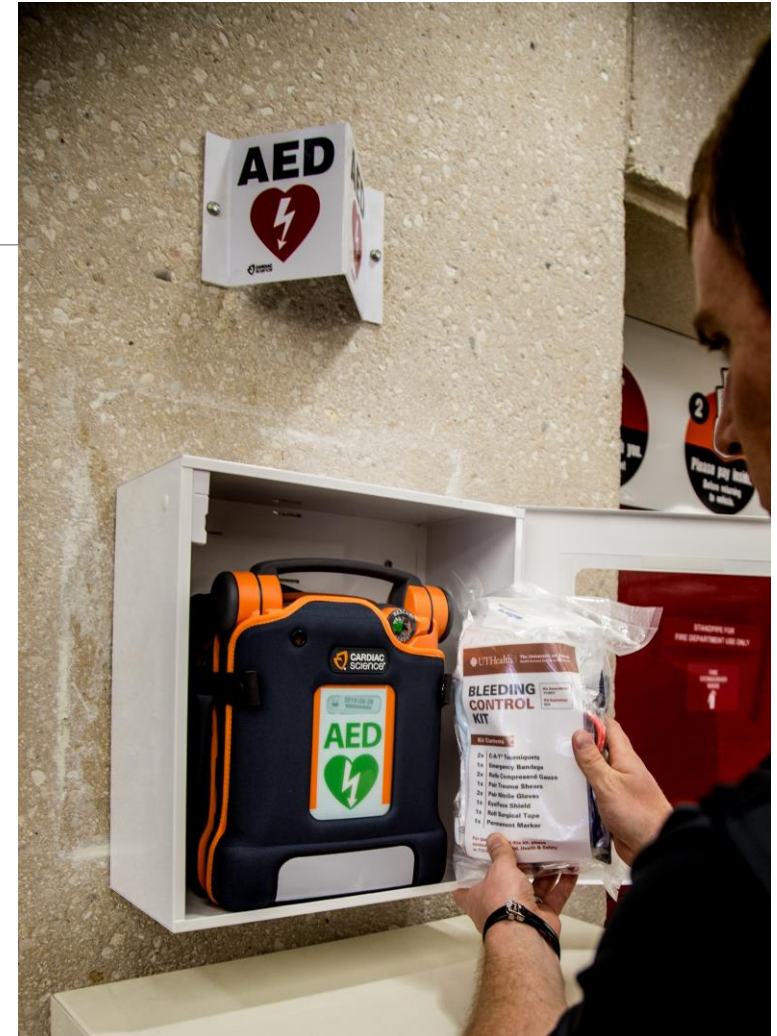

ASL Webpage

Safety, Health, Environment, and Risk Management

Safety, Health, Environment, and Risk Management

- [Home](#)
- [Submit a Safety Concern](#)
- [Contact Us](#)
- ▶ [Biological Safety](#)
- ▶ [Chemical Safety](#)
- ▶ [Radiation Safety](#)
- ▶ [Environmental Protection](#)
- ▼ [Occupational Safety and Fire Prevention](#)

- [Occupational Safety Home](#)
- [Fire Safety Report](#)
- [Area Safety Liason](#)**
- [Hotworks Fire Prevention](#)
- [Emergency Procedures](#)
- [Campus Apartment Emergency Evacuation](#)
- [High Rise Building](#)

Area Safety Liason

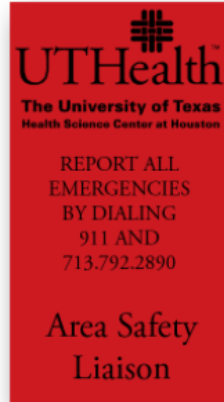

Area safety liaisons (ASLs) play an important role at UTHealth by assisting colleagues and other individuals in their area to be safe and healthy. The role of an ASL includes reporting safety hazards to EHS, reporting security concerns to UTPD, and facilitating evacuation during an emergency situation. The Occupational Safety and Fire Prevention Program helps to organize and administrate the ASL program by maintaining an active list of ASL volunteers, providing annual training to ASLs, and supporting ASLs who may have questions or concerns about their respective areas or buildings. Contact EHS if you are interested in serving as a volunteer ASL for your area.

Area Safety Liason Training, Information, and Forms

[OIA Emergency Communications](#) - Resources to know when the University is Open (Powerpoint)
[Injury Reporting](#) (Powerpoint)
[Environmental Management Systems](#) (Powerpoint)
[2020 ASL Training](#) (PDF)

Area Safety Liason Listings by Building

ASLs contacts:
[Campus wide ASL contact information](#) (Excel File)

Emergency Management Plan

High Rise Evacuation Video

Safety, Health, Environment, and Risk Management

Safety, Health, Environment, and Risk Management

Home

Contact Us

► Biological Safety

► Chemical Safety

► Radiation Safety

► Environmental Protection

▼ Occupational Safety and Fire Prevention

Occupational Safety Home

Fire Safety Report

Area Safety Liason

Hotworks Fire Prevention

Emergency Procedures

Campus Apartment

Emergency Evacuation

**High Rise Building
Emergency Evacuation**

High Rise Building Emergency Evacuation

UTHealth has multiple types of buildings located throughout its campus.

The film below can assist building occupants' in familiarizing themselves with critical building safety and emergency response features. This film will demonstrate to occupants the fire detection and suppression, occupant notification, and emergency exits. For additional information and resources please contact Environment Health and Safety at 713-500-8100



Please familiarize yourself with the process for evacuations at UTHealth Houston:

[High Rise Evacuation Video](#)

NEW! Building Specific Evacuation Videos

EXAMPLE:

McGovern Medical School emergency egress video

https://youtu.be/oRRDMLa_r9E

Mobility Assistance Program

During an emergency evacuation, it is important to make sure that all occupants can exit the building safely

- For those who require assistance in exiting the building, please have them complete the [Evacuation Assistance Request Form](#)
- This confidential assistance program can be short term or long term and halted at any time by the individual
- Individuals who are injured, pregnant, or otherwise in need of temporary assistance in the event of an emergency are eligible for this
- For those in a high rise, an Evacu-trac can also be made available to them

Mobility Assistance Program

Emergency Evacuation Assistance Request

UTHSC-H seeks to protect its community from the effects of unpredictable situations by establishing specific procedures for coping with local emergencies. If you need assistance to evacuate the building during such an emergency, please complete the form below and return it in person or via inter office mail to Environmental Health & Safety in OCB 1.330 or fax the form to 713-500-8111.

Upon receipt, a member of the Environmental Safety & Health team will be contacting you to confirm the delivery of the form, to discuss the program with you. He or she will then update the HFD Fire Depository Box and notify UTPD.

Name (please print): _____

Building and Room Number: _____

Phone Number: _____

I will need assistance in evacuating the building on a:

- ☐ Temporary basis from _____ until approximately _____
- ☐ Throughout my employment/studies at UTHSC-H
- ☐ I will no longer need emergency evacuation assistance

Comment: (optional) _____

A member of the Environmental Safety & Health team will be contacting you upon the receipt of this form to discuss the program and to ensure you know how to respond in the event of a building emergency. If you would like a more detailed, in person, discussion of the program, please check the box below:

- ☐ I would like a safety specialist to speak with me in person at my location about the evacuation concerns specific to my location and provide greater detail about the Emergency Evacuation Assistance Program.



Evacu-trac

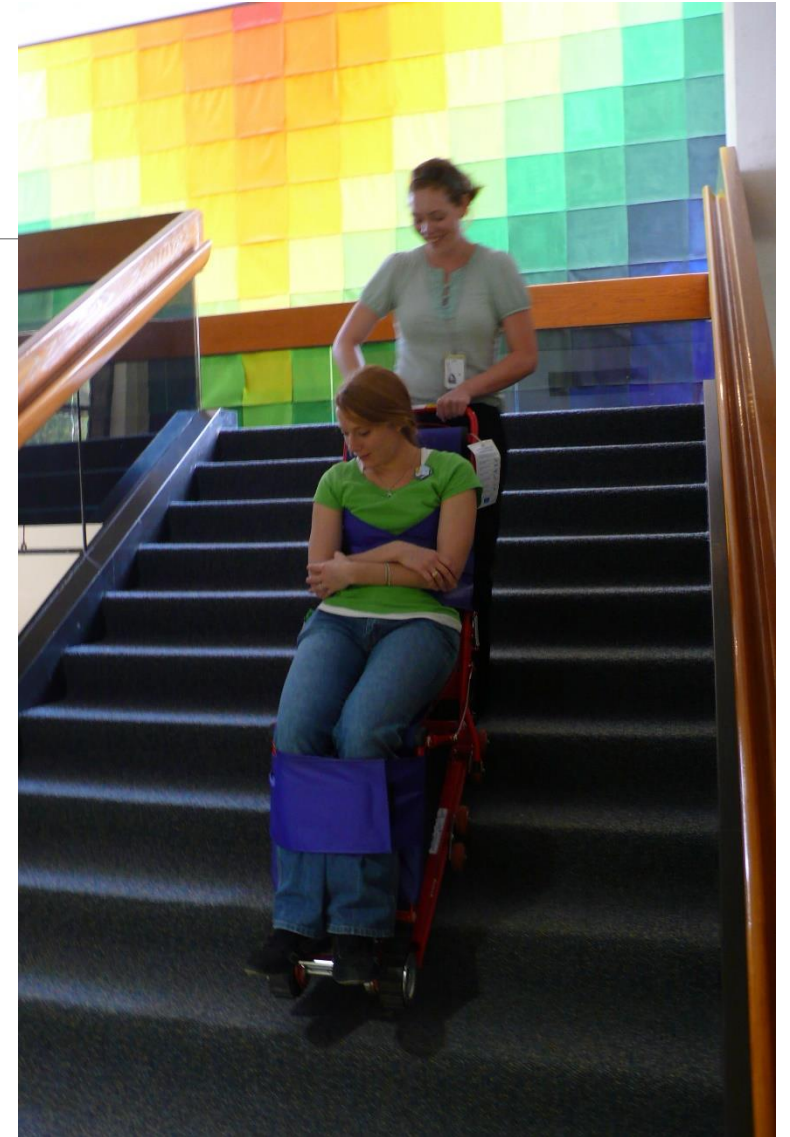



MegaMover Plus (UT Professional Building only)

ASL Updates and Work From Home

Please let us know if any changes are needed, such as:

- You are no longer able to serve as an ASL
- You are permanently working from home
- You know of an area that does not have representation of an ASL

Contact EHS at 713 500 8100

Additional EHS Safety Services

- Respiratory protection – fit testing
- Water testing and air quality monitoring
- Occupational monitoring and ergonomic assessments
- Clinic and lab safety training
- Bloodborne pathogens awareness training
- Fire extinguisher training and general fire safety
- Radiation safety training and X-ray surveys
- Infectious substance shipping training
- Hazardous waste pick up

For additional information on training, please visit:

<https://www.uth.edu/safety/training/index.htm> or call EHS at 713.500.8100

Please call Environmental Health & Safety for any safety concerns!

<i>EHS Main Office</i>	713.500.8100
Fire & Life Safety	713.500.8165
Biological Safety	713.500.8170
Chemical Safety	713.500.5832
Hazardous Waste Collection	713.500.5837
Radiation Safety	713.500.5840
EMAIL:	osfp.safety@uth.tmc.edu

Please visit our ASL webpage at:

<https://www.uth.edu/safety/occupational-safety-and-fire-prevention/asl.htm>

**Thank you to each and every one of you for
your service as an Area Safety Liaison!**



 **UTHealth[®] Houston**